

TOOLS REQUIRED:

- 4 mm Allen Key
- 6 mm Allen Key
- 13 mm Spanner

1

INSTALL PLATFORM PIVOT MOUNTS

From the platform kit, position pivot mounts into each pivot bracket, lining up the rivnut holes on the mounts with the holes on the brackets.

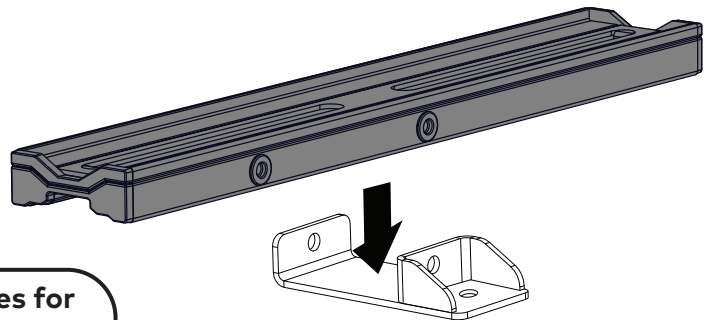

Where possible, always use the centre holes for attaching to pivot bracket. If extra clearance is needed due to platform-to-roof fitment needs, the offset holes can be used.

2

SECURE PLATFORM PIVOT MOUNTS

Secure all platform pivot mounts with x2 M6 x 16 mm cap screws with washer from the platform kit as shown.

Tighten all cap screws to 4 Nm with a 4 mm allen key or a suitable torque wrench.

NOTE - The pivot mount assembly will still have movement after securing which is intended.

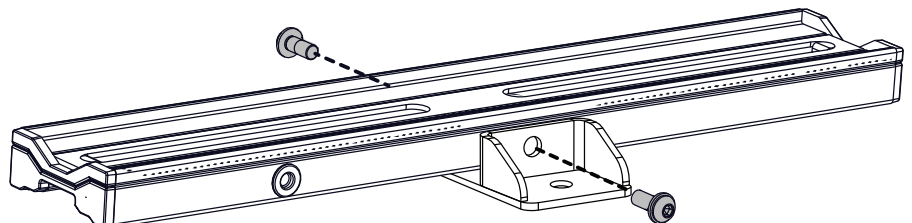

3**ASSEMBLE PIVOT BRACKET TO RUGGEDLINE**

Assemble pivot bracket with pivot mount along with the M8 hardware as pictured. Complete this for both M8 mounting holes on top of the RuggedLine.

M8 x 20 mm socket head cap screw

M8 washer

Pivot bracket with pivot mount assembly

M8 washer
M8 nyloc Nut

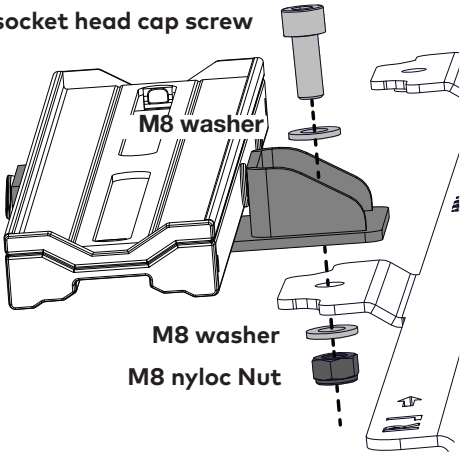
**4****SECURE PIVOT BRACKET ASSEMBLIES**

Tighten all cap screws with a 6 mm allen key, and all nuts with a 13 mm spanner or a suitable torque wrench.

Ensure all cap screws and nuts are tightened to 7 Nm.

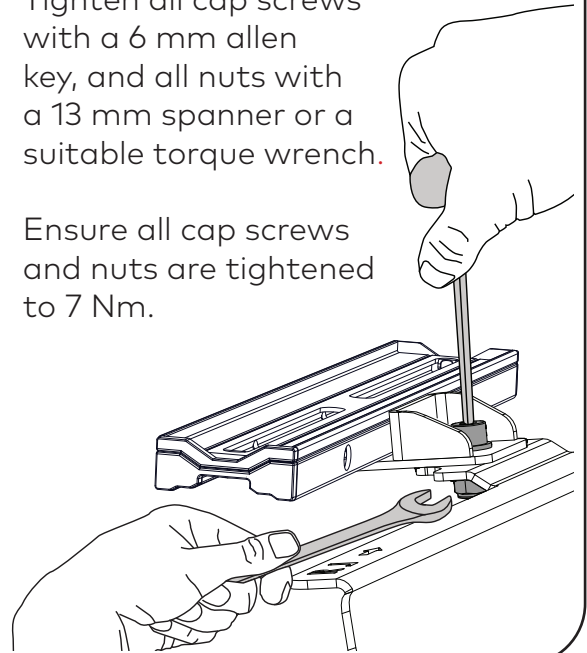
**!**

NOW SWITCH TO YOUR LOCKNLOAD PLATFORM INSTRUCTIONS AND CONTINUE FROM THE 'VEHICLE MOUNTING INSTRUCTIONS' PAGE.

YAKIMA®

www.yakima.com.au
www.yakima.co.nz
www.yakima.com
www.yakima.eu

YAKIMA AUSTRALIA PTY LTD

17 Hinkler Court
Brendale, QLD 4500
Australia
1800 143 548

YAKIMA PRODUCTS, INC.

4101 Kruse Way
Lake Oswego, OR
97035-2541
USA
888 925 4621
yakima.com/support

ALL CONTENT SUBJECT TO YAKIMA AUSTRALIA PTY LTD COPYRIGHT © 2024